

revision	date
1	11-3-2025
SITE PLAN REVISION	

1407 West Newport Center Drive  
Pompano Beach, FL 33069  
Phone 954.949.2200 Fax 954.949.2201  
Engineering & Consulting  
Kamm Consulting  
P.O. Box 8889  
Pompano Beach, FL 33069

KAMM

Consulting

11-3-2025

date

signed

Joefran Investments  
980 SW 12TH AVENUE  
POMPANO, FLORIDA

project title:  
sheet title:

SITE PHOTOMETRIC PLAN

proj. no.: 2025-0094  
project manager: GK  
checked by: RAK  
scale: AS NOTED  
date: 03/24/2025

sheet

E1.1

project

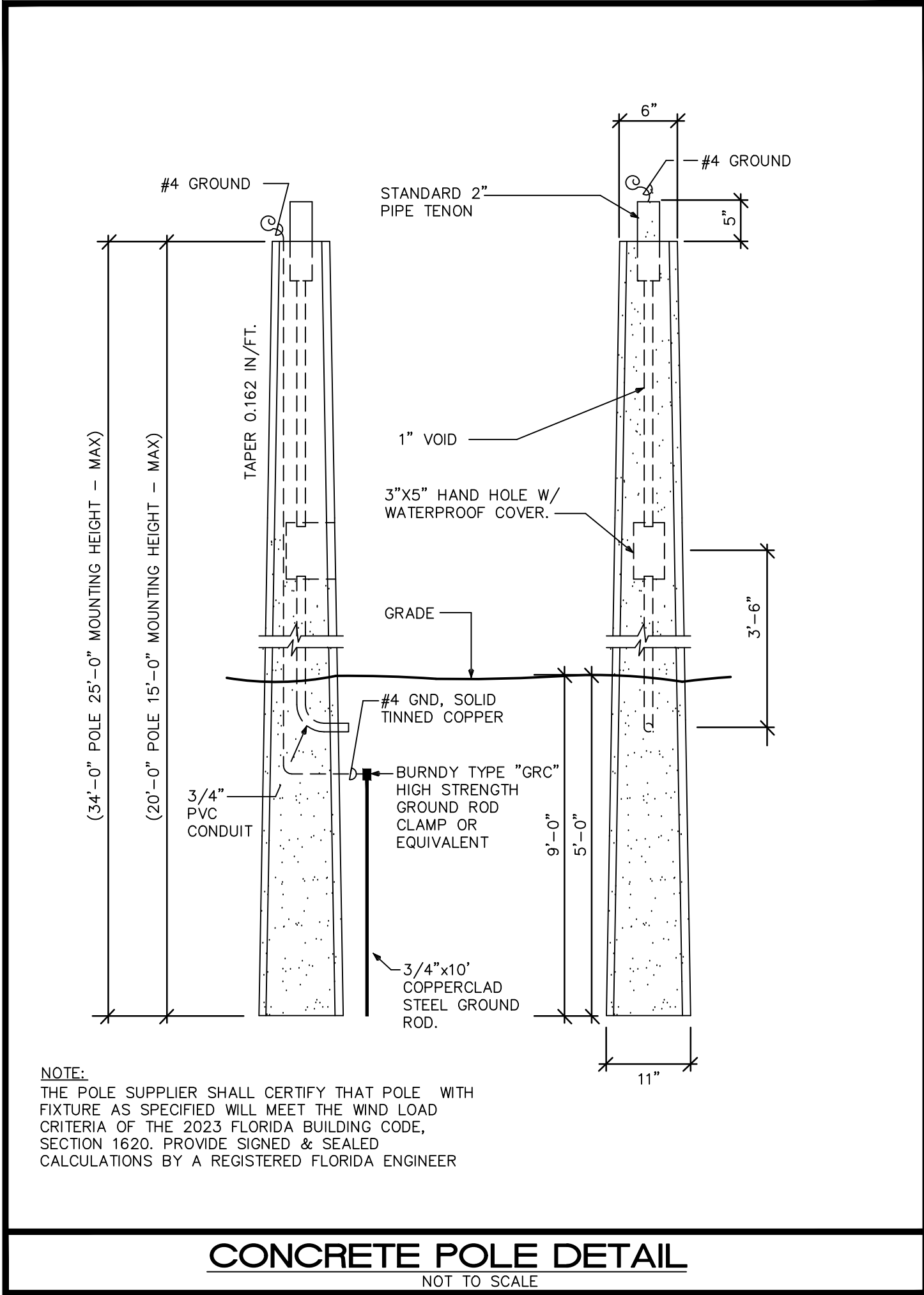

Luminaire Schedule									
Symbol	Label	[MANUFAC]	Description	Qty	Arrangement	Total Lamp Lumens	LLF	Lum. Watts	Total Watts
	P4	LSI LIGHTING	VALM-48L-4W-30K7	2	Single	N.A.	0.900	306	612
	P4W	LSI LIGHTING	VALM-18L-4W-30K7-IS	1	Single	N.A.	0.900	104	104

Calculation Summary							
Label	CalcType	Units	Avg	Max	Min	Avg/Min	Max/Min
PL-EAST	Illuminance	Fc	1.16	2.3	0.1	11.60	23.00
PL-SOUTH	Illuminance	Fc	0.31	0.8	0.0	N.A.	N.A.
PL-WEST	Illuminance	Fc	0.76	1.7	0.0	N.A.	N.A.
TRUCK PARKING_Planar	Illuminance	Fc	2.66	5.7	1.0	2.66	5.70

SOUTH ANDREWS AVENUE

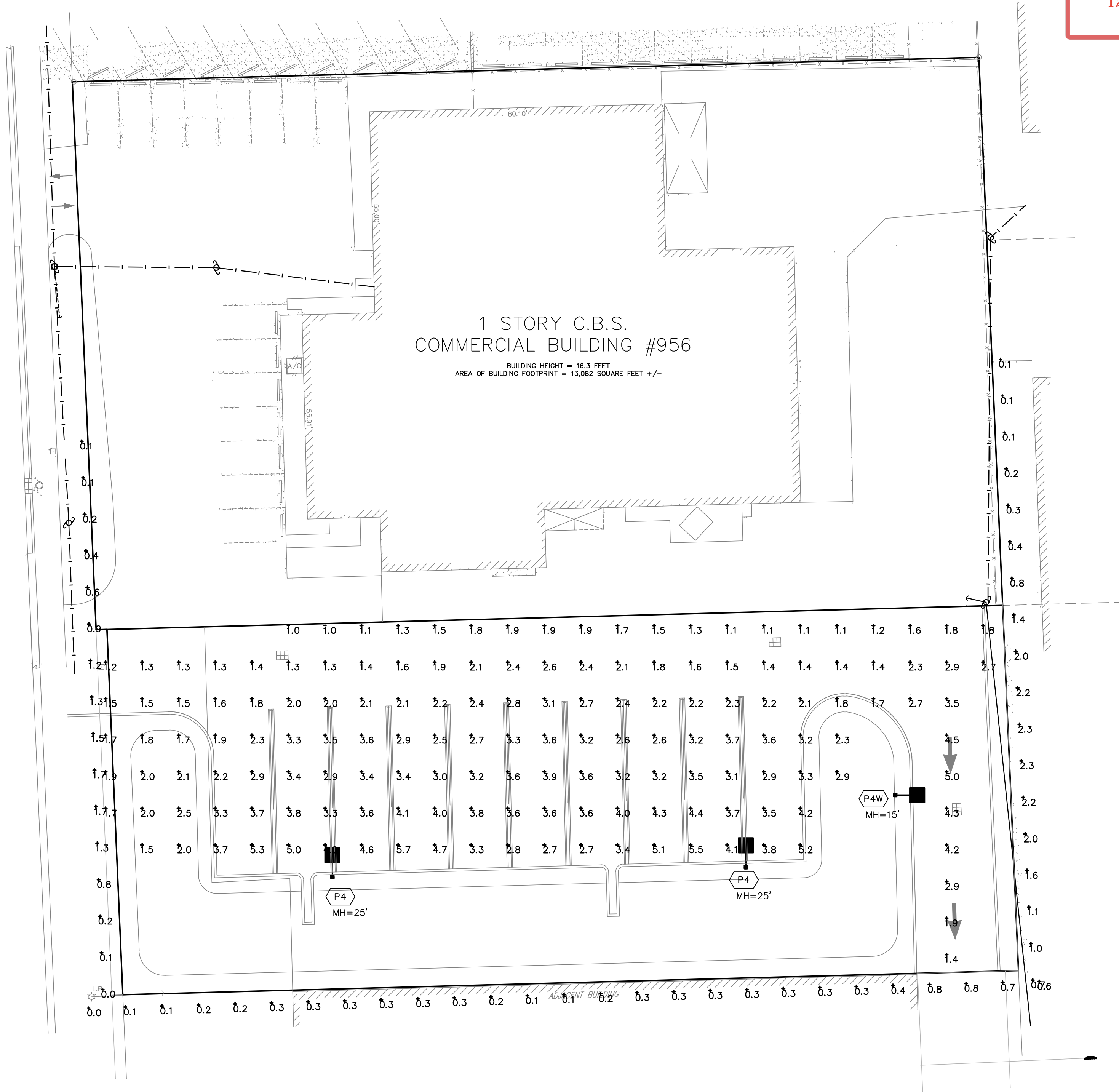

SITE PHOTOMETRIC PLAN

